



THE CORPORATION OF THE MUNICIPALITY OF RED LAKE MEMORIAL TREE PROGRAM

A memorial tree program is a unique way to provide a living tribute in commemoration of a friend or loved one. It can provide a sense of comfort and a site of reflection for the community.

The program will take place at Phillip Thomas Vinet Centennial Park and Rahill Beach

The social benefits include the harmonization of parks with the surrounding nature, as well as adding character and beauty to parks.

The cultural benefits include providing commemoration of the municipality's past community members, as well as showcasing Red Lake's natural environment in a protected setting.

There are many environmental benefits to this program. Trees filter and remove pollutants, carbon dioxide and sulphur dioxide. Trees use run-off water that would normally flow into our storm system and waterways. They provide homes, food and protection for birds and mammals. Trees also allow the elimination of monoculture that can devastate parks and forests.

The economic benefit of this program is subscription revenue would create a permanent reserve to ensure tree replacement, as required.

The subscriber will pay as per the tariff of fees. The Municipality creates a reserve with the revenue.

The subscriber receives:

- A vinyl plaque (5"x7") mounted on a 4"x4" PWT post elevated 12" above ground
- The plaque will be replaced if damaged or destroyed as long as subscriber is active in the program.
- Each plaque will be inscribed with three (3) lines of note, which shall be approved by the Operations Superintendent.
- A guarantee of ten (10) years of tree life. If a tree is not alive within ten years it will be replaced by the Municipality.
- A right of tree replacement with a renewal subscription if the tree dies after 10 consecutive years of life.

MEMORIAL TREE PROGRAM

Phillip Thomas Vinet Centennial Park Tree Planting Program	\$ 360.00 plus applicable taxes
Rahill Beach Tree Planting Program	\$ 360.00 plus applicable taxes



**THE CORPORATION OF THE MUNICIPALITY OF RED LAKE
MEMORIAL TREE PROGRAM CONTRACT**

NAME: _____

ADDRESS: _____

PHONE NUMBER: _____

EMAIL: _____

PREFERRED SPECIES: _____

LOCATION: _____
(Municipal staff will contact the donor to confirm location and availability)

PLAQUE INFORMATION:

The plaques are black with white lettering and are 5"x7" in size. There is room for 3 lines as shown below

IN LOVING MEMORY

JOHN AND MARY

JOHNSON

I, the undersigned, agree to the fee (\$ 360 Plus HST) and terms and conditions for a memorial tree as per the attached Tree Memorial Policy

Date

Donor's Signature

Municipality of Red Lake
2 Fifth Street
Box 1000
Balmertown, ON
P0V 1C0

Phone: (807) 735-2096
Fax: 866-681-2954
E-mail: municipality@redlake.ca



RAHILL BEACH TREE PLANTINGS: 2004 - 2012

(See attached map for tree locations)

<u>CODE</u>	<u>COMMON NAME</u>	<u>SCIENTIFIC NAME</u>
A1-A2	Green Ash	<i>Fraxinus pennsylvanica</i>
B1	Cutleaf Weeping Birch	<i>Betula pendula laciniata</i>
C1	Red Pine	<i>Pinus resinosa</i>
E1-E6	White Elm	<i>Ulmus americana</i> 'Brandon'
F1-F7	'Prairie Spire' Green Ash	<i>Fraxinus pennsylvanica</i> 'Rugby'
H1	Hackberry	<i>Celtis occidentalis</i> (adopted)
J1-J2	Butternut	<i>Juglans cinerea</i>
L1	American Basswood (Linden)	<i>Tilia americana</i>
M1, 2, 5, 8	Silver Maple	<i>Acer saccharinum</i> (adopted)
M3, 4, 6	Silver Maple	<i>Acer saccharinum</i>
M7	'Freeman' Maple	<i>Acer X freemani</i>
P1	Columnar Swedish Aspen	<i>Populus tremula</i> 'Erecta'
S1	Silver Buffaloberry	<i>Shepherdia argentea</i> (male plant)
W1, 2, 3	'Silky' White Willow	<i>Salix alba sericea</i> (adopted)
W4-W8	'Silky' White Willow	<i>Salix alba sericea</i>
W9	Laurel Willow	<i>Salix pentandra</i>



Rahill Beach Tree Plantings: 2004-12

(See attached sheet for explanation of codes.)



LEGEND

- turf
- wooded
- garden
- building



PHILLIP THOMAS VINET CENTENNIAL PARK TREE PLANTINGS: 2011
(See attached map for tree locations)

<u>CODE</u>	<u>COMMON NAME</u>	<u>SCIENTIFIC NAME</u>
A1-A9	'Prairie Spire' Green Ash	<i>Fraxinus pennsylvanica</i> 'Rugby'
B1-B3	Cutleaf Weeping Birch	<i>Betula pendula laciniata</i>
C1-C9	White Spruce	<i>Picea glauca</i> 'Densata'
E1-E4	White Elm	<i>Ulmus americana</i> 'Brandon'
F1-F7	'Prairie Spire' Green Ash	<i>Fraxinus pennsylvanica</i> 'Rugby'
G1-G5	'Gladiator' Rosybloom Crabapple	<i>Malus x adstringens</i> 'Durleo'
H1-H2	Black Walnut	<i>Juglans nigra</i>
J1-J2	Butternut	<i>Juglans cinerea</i>
K1-K2	Ohio Buckeye	<i>Aesculus glabra</i>
L1, L4	American Basswood (Linden)	<i>Tilia americana</i>
L2, L3, L5	'Harvest Gold' Linden	<i>Tilia mongolica</i> 'Harvest Gold'
M1-M4	Silver Maple	<i>Acer saccharinum</i> 'Silver Cloud'
P1-P6	Columnar Swedish Aspen	<i>Populus tremula</i> 'Erecta'
Q1-Q3	Bur Oak	<i>Quercus macrocarpa</i>
R1-R2	Northern Pin Oak	<i>Quercus ellipsoidalis</i>
S1-S2	European Mountain-ash	<i>Sorbus aucuparia</i>
X1-X3	Cottonwood (hybrid)	<i>Populus x canadensis</i> 'Prairie Sky'



Centennial Park Tree Plantings: 2011

(See attached sheet for explanation of codes.)

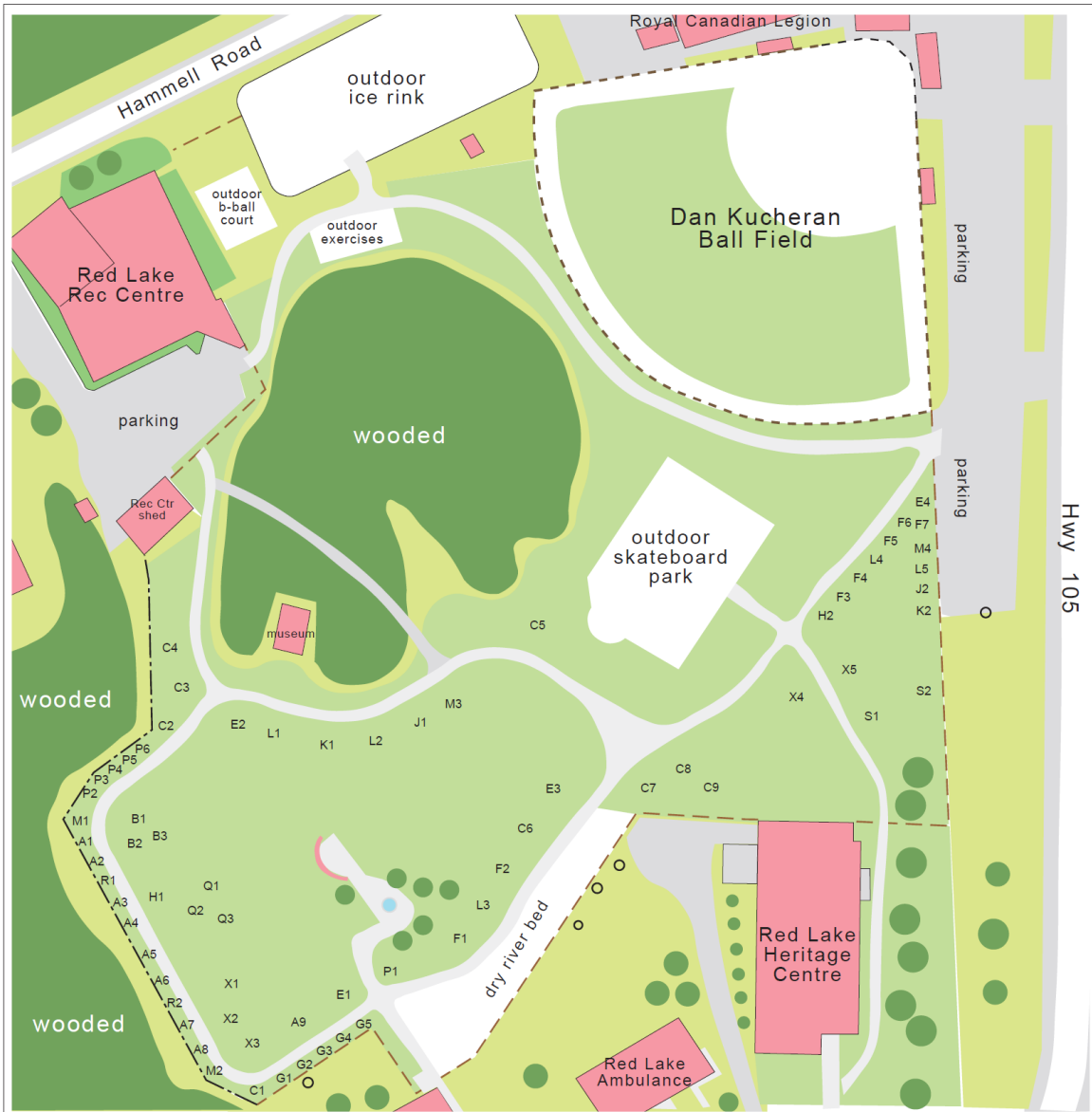

LEGEND sod coarse turf wooded garden building